

GP No. 1 & No. 2



The Gripple GP No. 1 and No. 2 are designed with a flat leading edge to create a stable end stop for trellis wires which utilize metal end posts.

FEATURES / BENEFITS

- Terminate and tension in one
- Ideal for use on steel wire, high tensile wire, and nylon monofilament
- High grade ceramic roller for corrosion resistance
- Spare integral channel allows safe tail wire return
- Tensioned using a Torq Tool and GP1 Adaptor in recessed applications
- Easily adjusted and released with the use of a Gripple Release Key



SPECIFICATION

Product	Wire Range	Standard Wire Gauge	Maximum Working Load
GP No. 1	5/64" - 1/8"	15 GA - 11 GA	880 lbs
GP No. 2	1/8" - 5/32"	10½ GA - 7½ GA	1,320 lbs

INSTALLATION

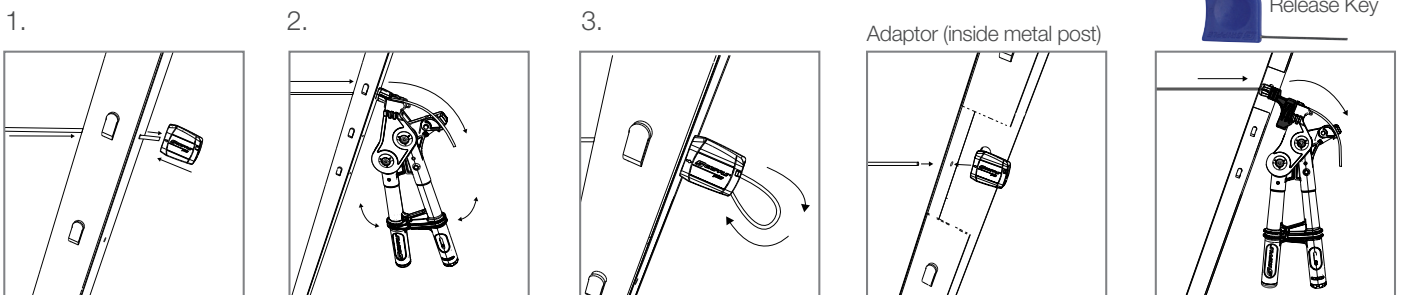

TIPS

- If the metal end post is installed 'open-side-out', there is a handy adaptor that can be fitted to the Torq Tool to make tensioning easier
- Press Release Key into smaller hole (not wire entry or exit hole) to move internal wedge to adjust or release wire



PI-GP-US

www.gripple.com

Gripple's policy is one of continuous development and innovation. We therefore reserve the right to alter specifications, etc. without notice.

Gripple Inc | 1611 Emily Lane | Aurora, IL 60502 USA
Tel 630 406 0600 Fax 630 406 0664 Email grippleinc@gripple.com