

## Accessory

The Gripple Torq Tool is lightweight, compact and tensions up to 6 mm Gripple tensioners.

## FEATURES / BENEFITS

- Lightweight and compact
- Designed with an in-built gauge, controls the tension applied to the wire
- One tool works on all Gripple tensioners on up to 6mm diameter wire
- Ensures consistent tension every time, optimising the life of wires
- Gear driven handles provide a 6:1 mechanical advantage, allows tensioning with minimal effort



## SPECIFICATION

Wire Range	Gauge Range	Max Working Load
Up to 6.00 mm	100 kg - 300 kg	400 kg

## INSTALLATION

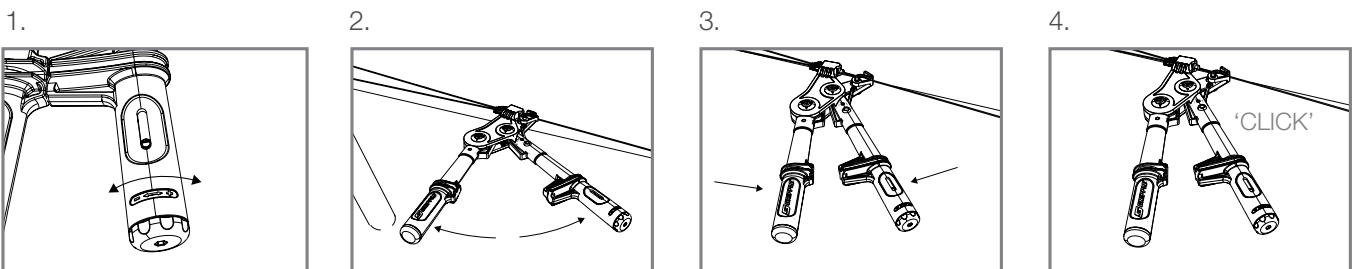

## TIPS

- If installing on a post which is 'open-side-out', there is a handy adaptor that can be fitted to the tool to make tensioning easier
- Regularly lubricate the cam area for smooth operation
- Replacement cam sets are available should the teeth wear



PI-TORQTOOL-ENG

[www.gripple.com](http://www.gripple.com)

Gripple's policy is one of continuous development and innovation. We therefore reserve the right to alter specifications, etc. without notice.

Gripple Ltd | The Old West Gun Works | Savile Street East | Sheffield S4 7UQ  
Tel 0800 018 4264 Fax 0114 275 1155 email [info@gripple.com](mailto:info@gripple.com)